

338 SPEAR STREET
RESIDENCE 3B
 floors 31-38

INTERIOR SPACE APPROX. 1703 SQ. FT. / 158.21 SQ. M.

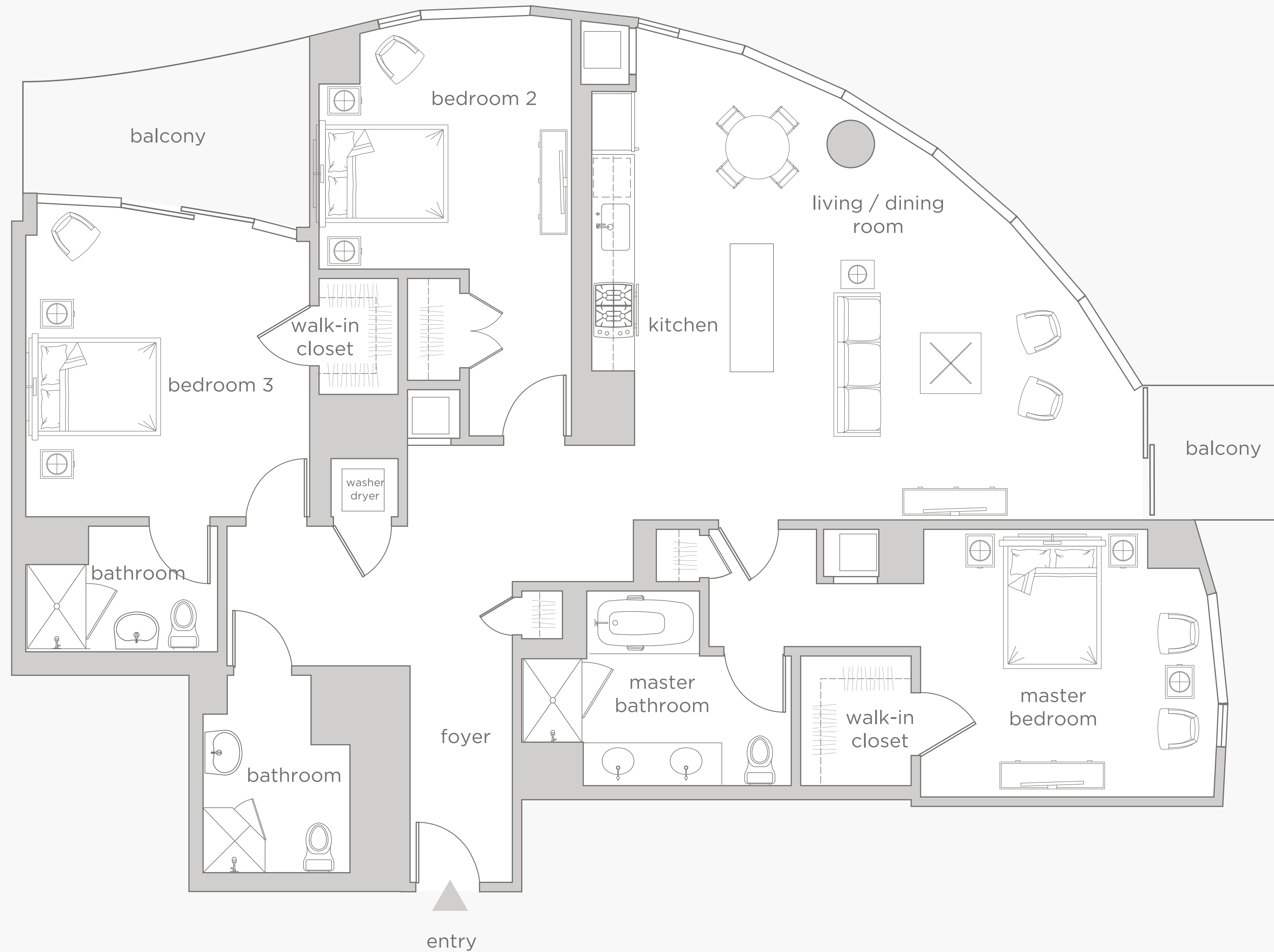

Residence Features

- Foyer entrance
- Three bedrooms
- Three bathrooms
- Living / Dining room
- Kitchen with granite countertops
- Studio Becker cabinets
- Poggenpohl cabinets (levels 37-38)
- Viking cooktop
- Thermador refrigerator
- Private master bedroom suite
- Master bathroom with tub, separate shower & double sink vanity
- Walk-in closet
- Bosch Washer / Dryer
- 9' ceilings in living room & bedrooms
- Expansive windows
- Two ipe hardwood balconies

Building Amenities

- 24-hour attended lobby
- Concierge
- 75 ft. lap pool
- 5,000 sq. ft. fitness center
- Treatment room and saunas
- Club lounge with catering kitchen
- Private screening room
- Business center
- Deeded parking
- Landscaped courtyard
- Elegant new restaurant by award winning San Francisco chef

