

PARK TOWNHOME B

LEVELS 3-4 APPROX. 1173 SQ. FT.
(1B shown, 2B similar)

PARK

Residences available:
One+Den, Two+Den,
Three+Den

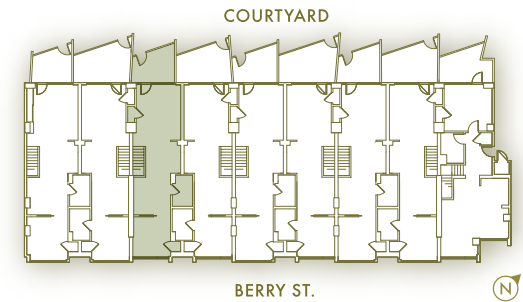
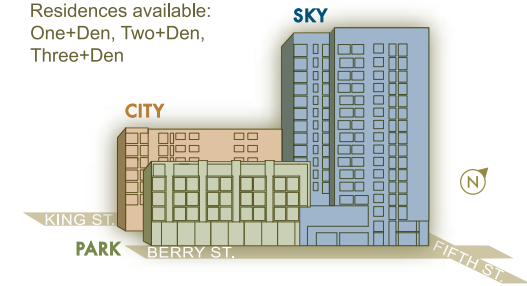

arterra
clean design. pure living.

Developer: Arterra Mission Bay, LLC. Exclusively represented by The Mark Company.
Sales Center: 628 Howard Street, San Francisco, California T: 415.974.5200
F: 415.974.5201 www.ArterraSF.com Pricing, availability, floor plans, elevations,
features and other information are subject to change by the builder without notice.
Maps, plot plans and depictions of homes or other improvements are artist's
conception and not to scale. © Arterra Mission Bay, LLC